

CITADEL I OFFICE SUBLEASE

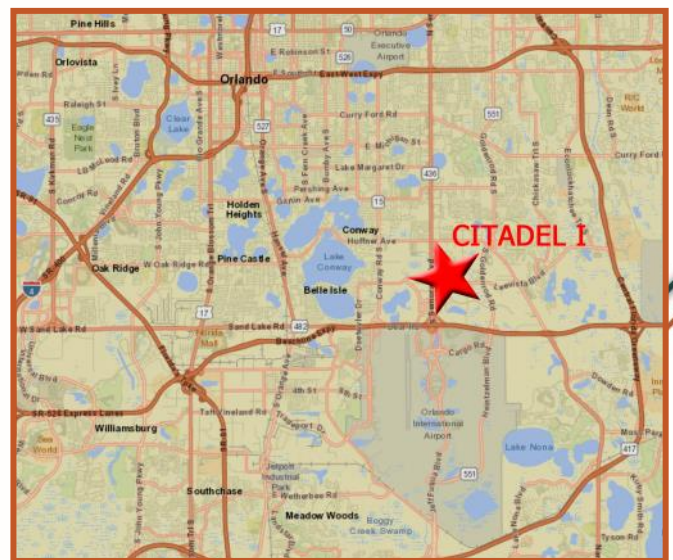

OFFICE SPACE SUBLEASE OFFERED WELL BELOW MARKET!

- ◆ 2,444 SQ FT OFFICE SPACE FOR SUBLEASE
- ◆ TURN KEY & READY FOR IMMEDIATE OCCUPANCY
- ◆ 5 OFFICES & CONFERENCE ROOM & RECEPTION AREA
- ◆ FURNITURE INCLUDED
- ◆ OFFERED WELL BELOW MARKET AT \$22.75 PER SQ FT (FULL SERVICE)
- ◆ LEASE TERM ENDS 10/31/21



Contact:
Scott Lloyd CCIM, RPA
Scott@LloydCA.com | Cell: 407-963-7558
100 S Eola Drive, Suite 200 | Orlando, FL 32801

COMMERCIAL
LLOYD
ADVISORS

BELOW MARKET OFFICE SUBLEASE



- ◆ TURN KEY & READY FOR IMMEDIATE OCCUPANCY
- ◆ FURNITURE INCLUDED
- ◆ FIRST CLASS BUILDING FINISHES
- ◆ AMPLE PARKING
- ◆ SECONDS FROM ORLANDO INTERNATIONAL AIRPORT & SR 528
- ◆ CONVENIENT TO GREAT SHOPPING, RESTAURANTS & HOTELS

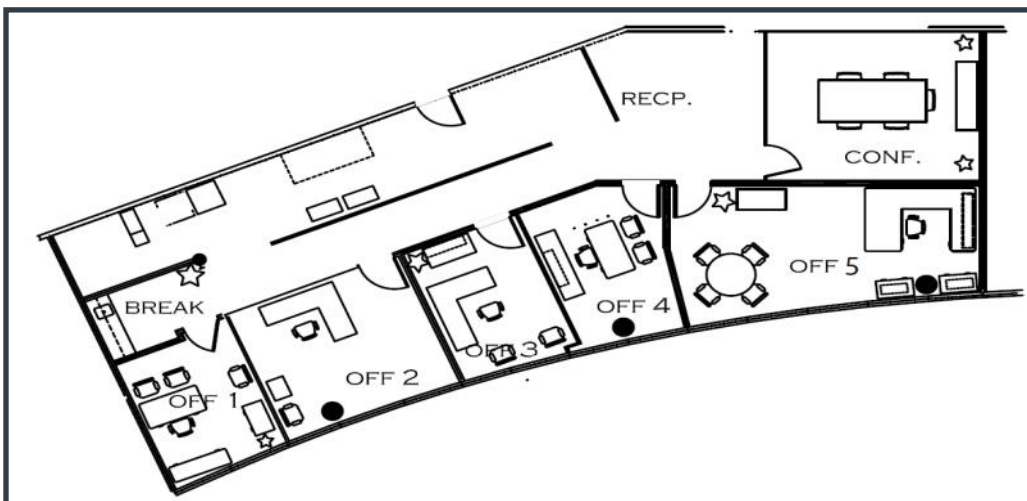

**5820 T.G. LEE BLVD
SUITE 250
ORLANDO, FL 32822
2,444 Square Feet
Move-in Ready**



Contact:
Scott Lloyd CCIM, RPA
Scott@LloydCA.com | Cell: 407-963-7558
100 S Eola Drive, Suite 200 | Orlando, FL 32801