

WAREHOUSE & OFFICE W/OUTDOOR STORAGE



540 MCDONALD AVE
AUBURNDALE FL

LIGHT MANUFACTURING OR SERVICE SPACE W/YARD STORAGE

- ◆ 7,400 SQ FT OFFICE & WAREHOUSE
- ◆ ZONED HEAVY INDUSTRIAL (City of Auburndale)
- ◆ EXCELLENT CONDITION WITH NEWLY REMODELED OFFICES
- ◆ 400 AMP/3-PHASE
- ◆ NEW HVAC SYSTEMS
- ◆ .57 ACRE WITH OUTDOOR STORAGE OR PARKING
- ◆ LOCATED < .5 MILES FROM DOWNTOWN AUBURNDALE
- ◆ \$6.00 PER SQ FT (NNN)

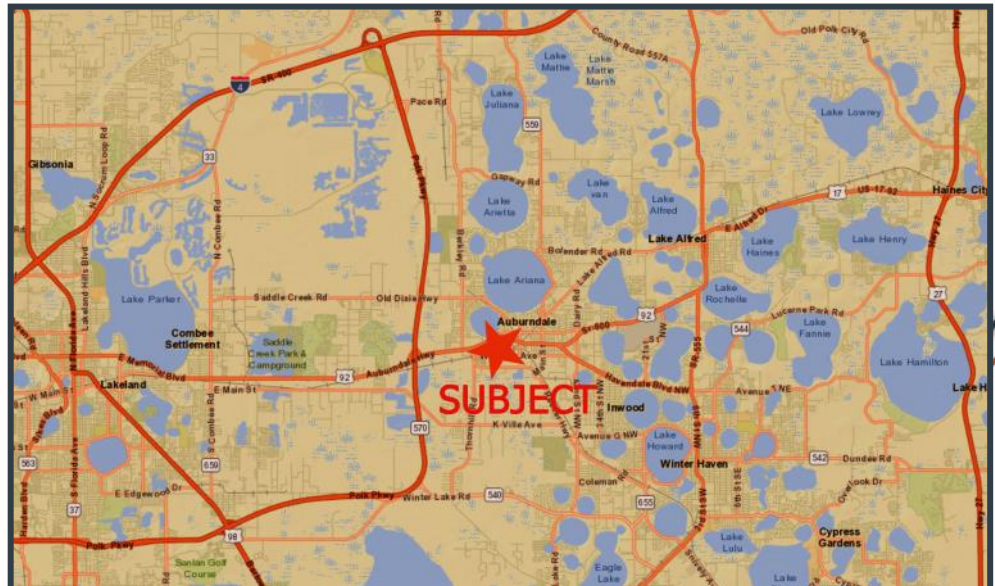

Contact:
Scott Lloyd CCIM, RPA
Scott@LloydCA.com | Cell: 407-963-7558
100 S Eola Drive, Suite 200 | Orlando, FL 32801

COMMERCIAL
LLOYD
ADVISORS

AUBURNDALE OFFICE, WAREHOUSE & OUTDOOR STORAGE



**540 MCDONALD AVE
AUBURNDALE, FL 32823**



**CENTRALLY LOCATED IN THE
HEART OF POLK COUNTY**

Contact:

Scott Lloyd CCIM, RPA

Scott@LloydCA.com | Cell: 407-963-7558

100 S Eola Drive, Suite 200 | Orlando, FL 32801

COMMERCIAL
LLOYD
ADVISORS

AUBURNDALE OFFICE, WAREHOUSE & OUTDOOR STORAGE

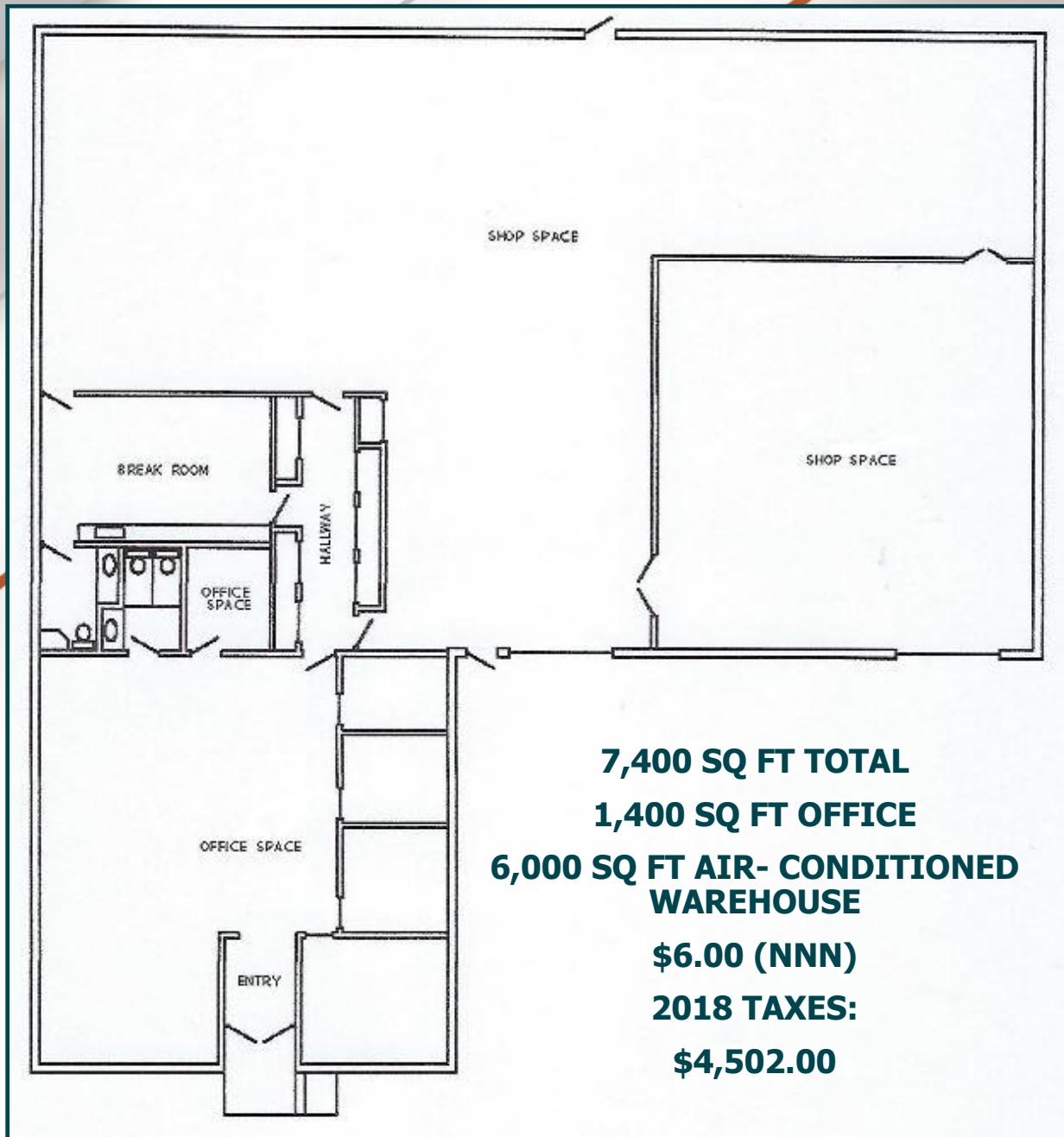

**540 MCDONALD AVE
AUBURNDALE, FL 32823**

COMMERCIAL
LLOYD
ADVISORS

Contact:
Scott Lloyd CCIM, RPA
Scott@LloydCA.com | Cell: 407-963-7558
100 S Eola Drive, Suite 200 | Orlando, FL 32801